

# For Lease

## 29,656± Sq. Ft. - 122,086± Sq. Ft.



### **Union Seventy Center** **3901 Union Blvd. - Suite 135** **St. Louis, MO 63115**

Lease Rate: First Level  
**\$2.95/ Sq. Ft., NNN**  
Second Level  
**\$1.00/ Sq. Ft., Gross**  
Contact: **Brendan O'Brien**  
**Brennan Gaffney**  
**Peter Newton**

- 29,656± Sq. Ft. First Level
- Expandable to 122,086± Sq. Ft. ,  
With 92,430± Second Level Space
- Automated Pallet Lift & Freight Elevator to Second Level
- 15' -20' Ceiling Heights
- Ten (10) Truck Docks with Load Levelers & Weather Seals
- One (1) Drive-in Door
- 24 Hour Security



Office Industrial Retail Institutional Investment Management



Commercial Real Estate  
1401 S. Brentwood Blvd.  
Suite 650  
St. Louis, MO 63144  
[www.hillikercorp.com](http://www.hillikercorp.com)

## 314 781 0001

 Individual Membership in the Society  
of Industrial and Office Realtors

Union Seventy Center  
3901 Union Blvd. - Suite 135  
St. Louis, MO 63115

Contact: Brendan O'Brien  
Brennan Gaffney  
Peter Newton

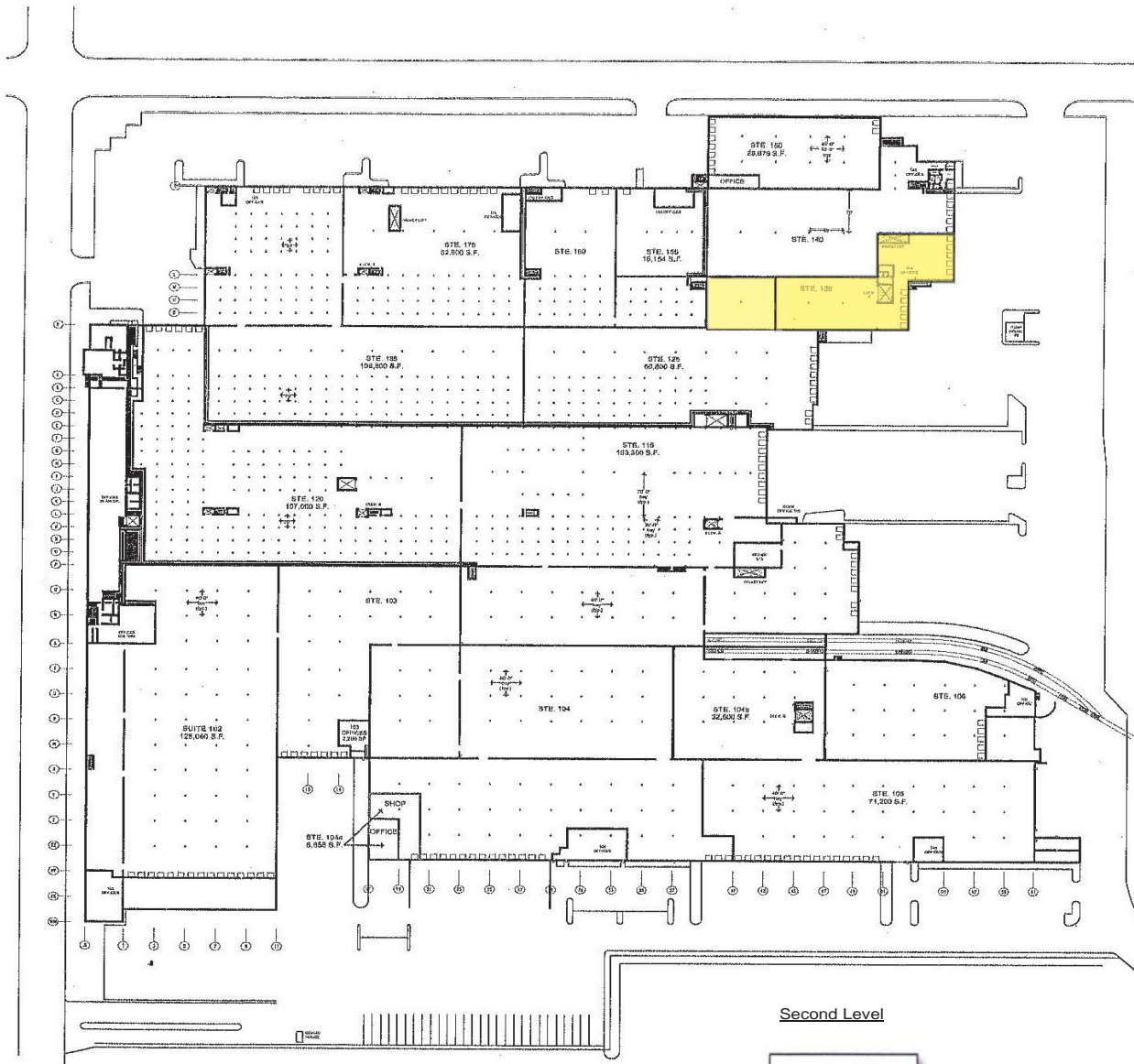

**UNION SEVENTY CENTER**  
*Business Park*

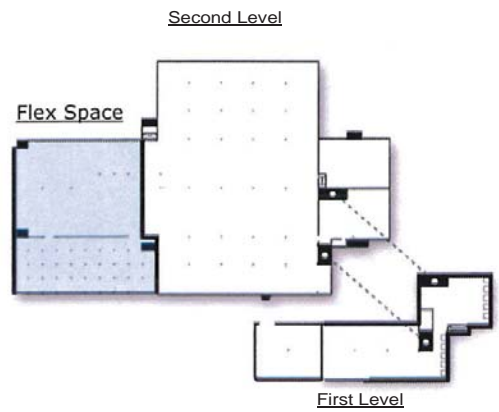

Office    Industrial    Retail    Institutional    Investment    Management



Commercial Real Estate  
1401 S. Brentwood Blvd.  
Suite 650  
St. Louis, MO 63144  
[www.hillikercorp.com](http://www.hillikercorp.com)

**314 781 0001**

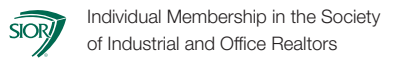

Information is from appropriate sources but is not guaranteed. No representation is made to environmental or other conditions of property. We recommend purchaser investigate fully.